

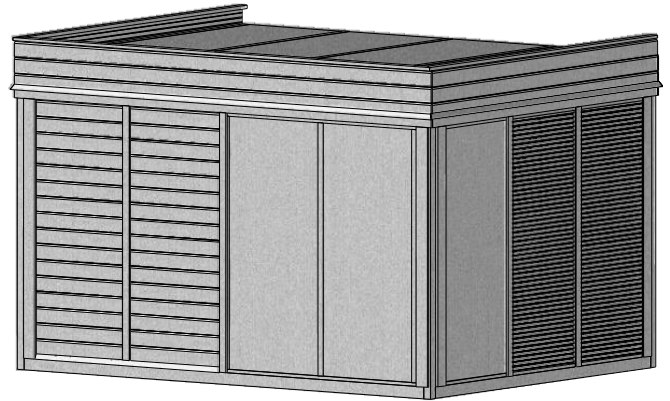

Hot Barrel

Sauna Cube

Specifications



Inside area, m2	12
Wood	Spruce
Shape	4 corners
External dimensions (WxD), mm	4286x2818
Number of windows	2
Size of doors (WxH), mm	2000 x 2200
Weight, kg	2000
Numer of persons	6
Assembling hour (2 people)	6

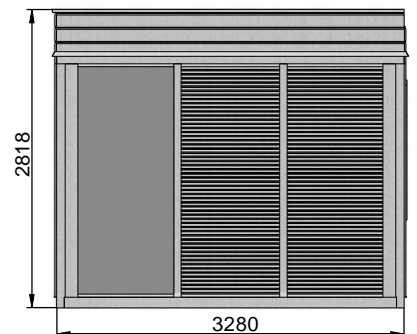
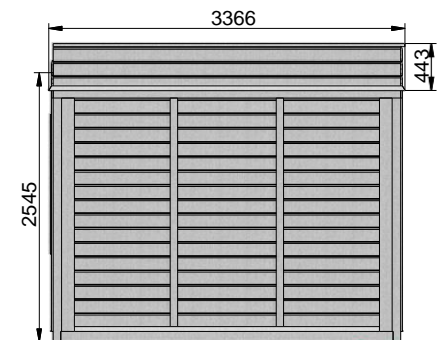

Standard Set

- Garden cube frame from spruce;
- Wooden floor;
- Roof covered with bitumen weld coating;
- 4 Standard full panel walls;
- 3 Decorative sunscreen walls with tempered glass;
- 2 Wooden tempered glass walls;
- 4 Insulated full panel walls;
- 2 Insulated full panel walls with small windows;
- 2 Insulated roof panels;
- Sauna benches;
- Three spaces inside: a sauna room, lounge room and a changing/shower room;
- Heat-resistant plates for the heater/stove;
- Aluminium sliding doors system Alutech;
- Inside glass doors;
- Changing room doors/partition.

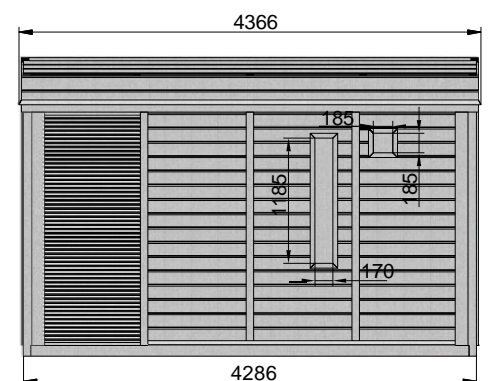
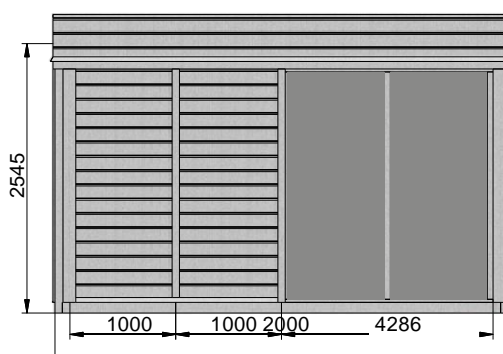

GENERAL INFORMATION

FRAME

The frames are made from glue laminated spruce beams. Frame consists of bottom frame (140 x 100 mm), columns (140x 140mm), top frame (140x 240 mm) and withstands 470kg/m² roofload.

THE WALLS

The 1000 x 2200 mm walls are made of spruce wood from FSC-certified spruce forests of Northern Europe. The light, golden-white spruce are ideal for Cubes constructions designs.



Standard full panel wall



Decorative sunscreen wall with tempered glass



Wooden tempered glass wall

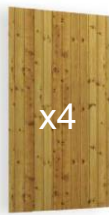

Insulated full panel wall

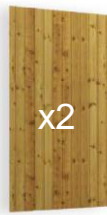

Insulated full panel wall with small windows

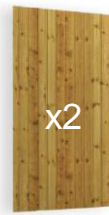

Insulated roof panel

Standard full panel wall. Wall frame 75 x 45 mm, panel covered with inside 96 x 12 mm and outside 145 x 18 mm horizontal spruce cladding boards.

Insulated full panel wall. Wall frame 75 x 45 mm, panel covered with inside 96 x 12 mm and outside 145 x 18 mm horizontal spruce cladding boards.

Insulated full panel wall with small windows. Wall frame 75 x 45 mm, panel covered with inside 96 x 12 mm and outside 145 x 18 mm horizontal spruce cladding boards. Size of windows: 180x1200 mm and 200x200 mm.

Decorative sunscreen wall. Wall frame 75 x 45 mm, horizontal sunshade wall consists of 18 x 95 mm boards.

Wooden tempered glass wall. Wall frame 75 x 45 mm with full tempered glass window.

THEROOF



- 1 Base;
- 2 Polymer modified bitumen;
- 3 Polymer modified bitumen;
- 4 Surfacing;
- 5 Protective membrane.

The roof panels are built with double rafters construction and covered with 18 x 145 mm finishing boards. This construction withstands 442 kg/m². All GardenCube buildings roof are 2.7 m high and 1.310 (2.29%) slope.

We use an hydro-insulating SBS to ensure the highest level of waterproofing. MIDA UNIFLEKS - modified bitumen weld coating. It is produced in two types: surfaced with quartz sand - for the bottom layer of the roofing and surfaced with slate that ensures perfect UV-protection - for the top hydro-insulating protective layer of the roofing for Cube roofs.

Service life of MIDA UNIFLEKS roofing is 30-40 years. This is the most popular solution for a living roof.

THE DOORS

Aluminium sliding doors system Alutech. Sliding parts are framed with aluminum frames, manufactured from "cold" single-chamber of aluminum profile with non-insulating gaskets. Sliding of the aluminum frame is made so that the entire structure is stable. Frames wheels designed for attachment to the motion and has aluminum profiles for vertical and horizontal adjustment, provides a particularly easy movement of moving parts.

Sealing brush prevents dust from entering the structure and compensates for vibration in the wind. All moving parts are very easy to remove and put it back, so there is no problem with cleaning glass from the outside.

In the closed position system has automatically locked and unlocked positions. Handles and locks built into the aluminum profile, so during the opening, the glass always remains clean.

Characteristics of system:

System profile-wide of 30mm frame;

Door profile depth of the frame and the sash- 45 mm;

Glass thickness- 6 mm;

This is single-chamber Aluminium system.

THE RAINWATER PIPES



The rainwater pipe package includes 4 m straight gutter and all parts needed for installation.



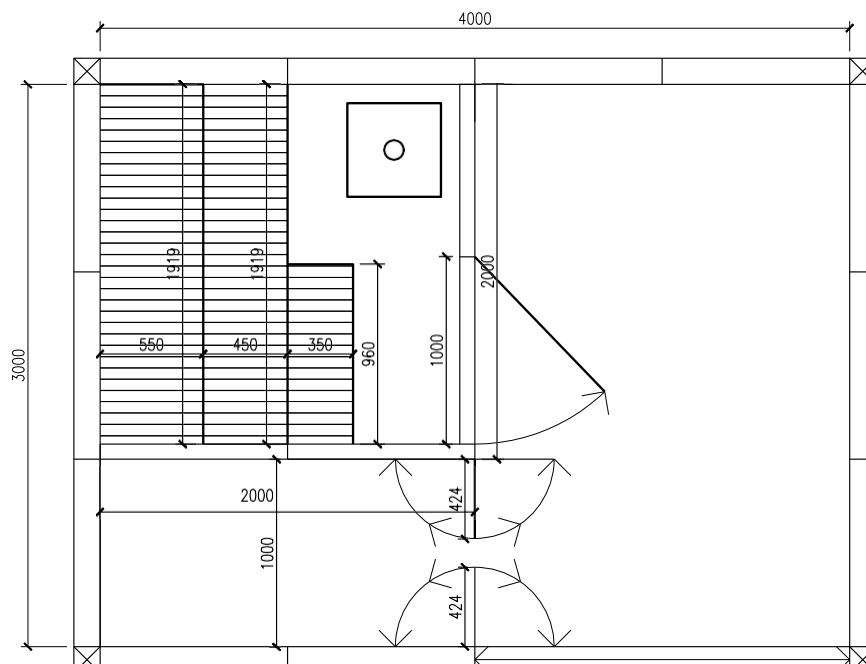

Down pipe package includes 2.5 m down pipe and all parts needed for installation.

No need for exact measurements and calculations, easy to transport and install, as all components needed are packaged compactly in a single package, ensuring safe delivery and easy installation.

FLOOR PLAN



HEATER AND CHIMNEY KITS

<p>ELECTRIC HEATER HARVIA ASSA 6KW 400V</p>	<p>Reliable and affordable basic stove. Harvia Assa is a traditional wall-mounted heater with the best price and quality. The operating switches are placed at the bottom of the stove. Heater is a stylish black color. Stones and 400V connection included. The recommended size of the sauna room is 5–8 m³.</p>	
<p>ELECTRIC HEATER HARVIA VEGA BC80 8KW 400V; BC90, 9KW 400V</p>	<p>Harvia Vega is an elegant heater that is easy to use. The stainless steel outer casing of the heater gives your sauna a modern look. The operating switches are placed ergonomically in the upper part, on the side of the heater, which provides easy operating. Stones and 400V connection included. The recommended size of the sauna room is 5–14 m³.</p>	
<p>ELECTRIC HEATER HARVIA CLUB 13.5 13.5KW 400V</p>	<p>The floor-mounted Club electric heaters are of the world-famous Harvia quality. They are completely made of stainless steel and provide the power and durability required for heavy-duty use. The Club heaters are controlled by a separate control unit Griffin CG170. The recommended size of the sauna room is 11–20 m³.</p>	
<p>WOODBURNING STOVE „HARVIA M3“ 16.5KW</p>	<p>A stylish stove for the smaller saunas. The Harvia M3 has a classic design and is suitable for the smaller wood burning saunas. A recommended size of the sauna room is 4.5–13 m³. Stones and standard chimney KIT included.</p>	
<p>WOODBURNING STOVE „HARVIA PRO 20“ 24.1KW</p>	<p>With a heater Harvia 20 Pro you can have a good hot bath in the medium-sized saunas. It has a big space for stones and an air-flow spoiler made of stainless steel. A recommended size of the sauna room is 8–20 m³. Stones and standard chimney KIT included.</p>	
<p>WOODBURNING STOVE „HARVIA M3 SL“ 16.5KW</p>	<p>The SL model (outside firewood feeding) is designed for people who want to conveniently heat their sauna from an outside. Stones and standard chimney KIT included.</p>	
<p>WOODBURNING STOVE „HARVIA SL20“ 24.1KW</p>	<p>The SL 20 model (outside firewood feeding) is designed for people who want to conveniently heat their sauna from an outside. Stones and standard chimney KIT included.</p>	
<p>STANDARD CHIMNEY KIT</p>	<p>A Standard chimney KIT is made from stainless steel. This Standard chimney can withstand 450 degrees gas. Its outer diameter is 20 cm, and inner diameter is 11.5 cm.</p>	
<p>„LUXURY“ CHIMNEY KIT</p>	<p>A „Luxury“ chimney KIT is CE marked (under 1856-1 EN European Standardization Certificate). It is made from shiny stainless steel. It either use AISI 316 and/or AISI 304 as standards and insulation. This „Luxury“ chimney can withstand 600 degrees gas. Its outer diameter is 17 cm, and inner diameter is 11.5 cm.</p>	

TYPE OF WOOD

SPRUCE



We mainly use Nordic spruce, which comes from Scandinavia. The light, golden-white softwood radiates a friendly warmth. Every single board used for our Sauna Barrel has its own individual character and history, and this makes our Sauna Barrel a real natural and unique product.

TRANSPORTATION

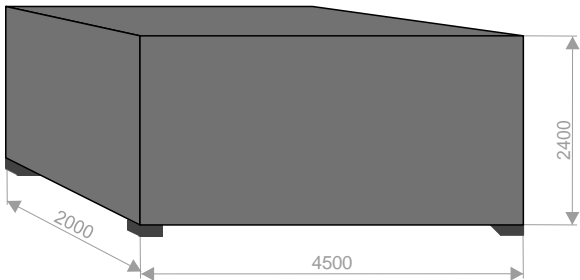

Sauna Cube KIT

The Sauna Cube is delivered to a customer not assembled (packed on a pallets (KIT)) but fully complete. Assembly instruction of Sauna Cube you can download and print from www.hotbarrel.co.uk.

SPECIAL FURNITURE SET

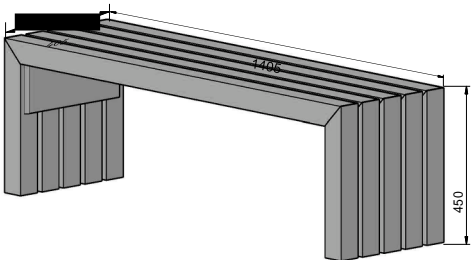
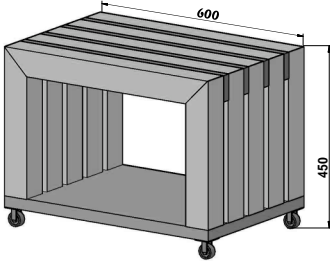
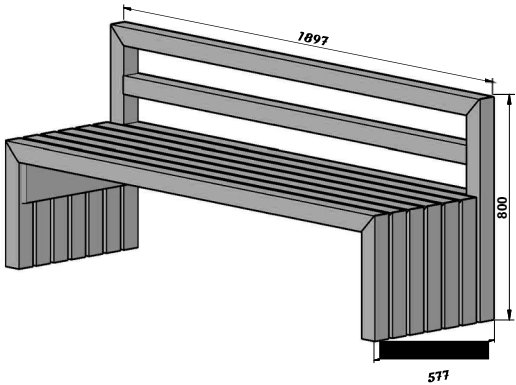

ACCESSORIES



WOODEN LADLE

Wooden ladle is great for sprinkling water on the stones to create a sauna steam.



HEAD REST

The elegantly designed head rest is a beautiful touch for your sauna. As well it is a comfortable accessory.



SAUNALIGHT

Protection level IP44. Bulb E14 (max. 40 W) is not included in the delivery



SAUNALIGHT COVER

Beautiful wooden sauna light cover.



THERMOMETER - HYDROMETER

Thermometer - hydrometer helps you to keep an eye on both the sauna temperature and air humidity.



BACK REST

Back rest helps to sit more comfortably in the sauna. Alder or aspen wood.



CLOTHESHANGER

An excellent solution for hanging towels in the changing room. It is made from durable wood and is wall-mounted.



WOODEN BUCKET FOR WATER

Our wooden buckets are of high-quality. The plastic inner part prolongs a life of the product and makes the cleaning easy.



22 LITERS WATER TANK

The water tank (22 l) is mounted directly above the heater. The water heats up quickly because the pipe going through the tank functions as a wall of the water tank.



ELECTRIC OVENS SAFETY FENCE

Safety fence is made from aspen or alder wood. It protects and allows to keep a proper safety distances from hot heaters.



SAUNAHATS

Sauna hats made from 100% wool (800 g/m²) with a place for your picture, logo or phrase.



DOOR SILL

Stainless steel door sill protects the interior from scratches and dirt.



PENDANT LIGHT

Wooden pendant light to light up your sauna cube.

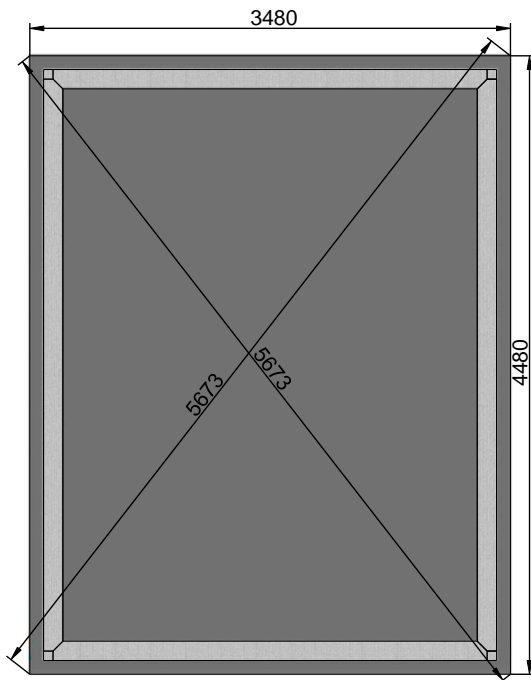

It is very important to have a proper foundation for your sauna. Therefore we recommend making the foundation according to the sketches here.

First of all, foundation must be prepared according to the landscape and ground conditions. Consult a qualified builder or an engineer to prepare a proper foundation, which fits your location. Make sure to complete the site preparation and the foundation before unpacking and assembling the sauna.

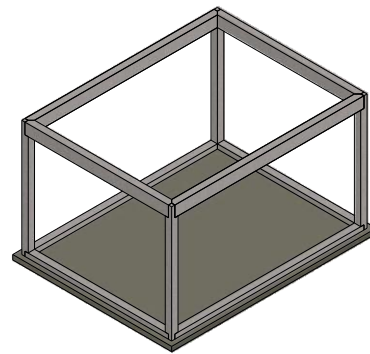

USAGE

Saunas typically take 30-40 minutes to heat up. The recommended temperature is 80-90° C. The thermometer should be located at head level in the sauna. It should be located away from the heater or the door so it will not give a false reading.

Enjoy the many health benefits of relaxing heat in your own Sauna Barrel just remember that staying in the hot Sauna for long periods of time makes the body temperature rise, which may be dangerous. The recommended time inside a Sauna Barrel is from 10 to 15 minutes. Take a five-minute break and then repeat. Also you should keep safety instructions and keep away from the stove when it is hot. Never throw water on the stones when there are people near the stove, because hot steam may

burn their skin. Be very careful when moving in the Sauna, as the benches and floors may be slippery. Do not hang clothes to dry in the Sauna, as this may cause a risk of fire.

Also check your body for any metal (jewelry and zippers, for example) in order to prevent it from burning your body when it quickly heats up in the facility.

We strongly recommend shouldn't use the Sauna to pregnant women and neither should young children.

MAINTENANCE

As wood is a natural material, it can change through time. Cracks of various sizes, changes of the color as well as a structure of the wood are not the errors, but a feature of a wood.

Natural wood (not impregnated) becomes grayish after having been left untouched for a while. Later it can turn blue and get covered with the mold. Therefore, you should immediately impregnate the wood to protect the products.

We strongly recommend that you impregnate the door and windows with a wood impregnation agent both the inside and outside of them, because the doors and windows can become twisted otherwise. In general, we

recommend consulting a specialist regarding the paints suitable for an unprocessed softwood and follow the manufacturers' of paints instructions. Properly painting the Sauna Barrel will

extend its lifetime. Besides that, we suggest you thoroughly inspecting the Barrel every six months and checking if it needs re-painting or else.

It's NOT advisable to paint the Sauna walls before assembling it – this is best done when the Sauna Barrel has been already assembled and when the weather is fine. However, if you wish to paint some parts in different colors, this should be done before the Sauna is assembled.

